

Panel Heater Instruction Manual

Panel Heater Usage Guidance

Please read this guidance carefully before using the electrical appliance



IMPORTANT, RETAIN FOR FUTURE REFERENCE: READ CAREFULLY

ASSEMBLY INSTRUCTION

Assemble before you use:

Please assemble the feet and the body in the order given in the picture below:

1. Place the convector on the flat desk or carton.
2. Insert the 4 position holes of the feet into the position holes of the body.
3. Tight the fixed screw to connect body and feet.

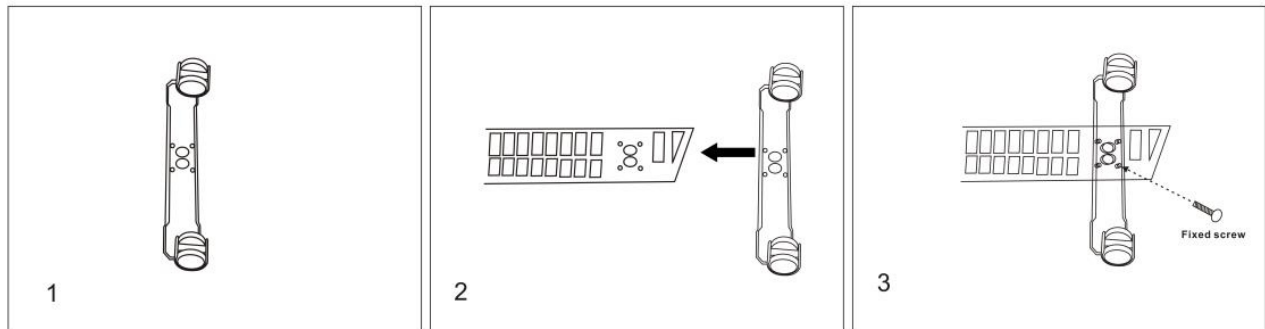

Technical parameters:

Product Name	Model number	Rated Voltage (V)	Rated Frequency (Hz)	Rated power (W)
Panel Heater	820-270BK	230	50	1300
Panel Heater	820-270WT	230	50	1300

Features and Usage:

A, Product structure:

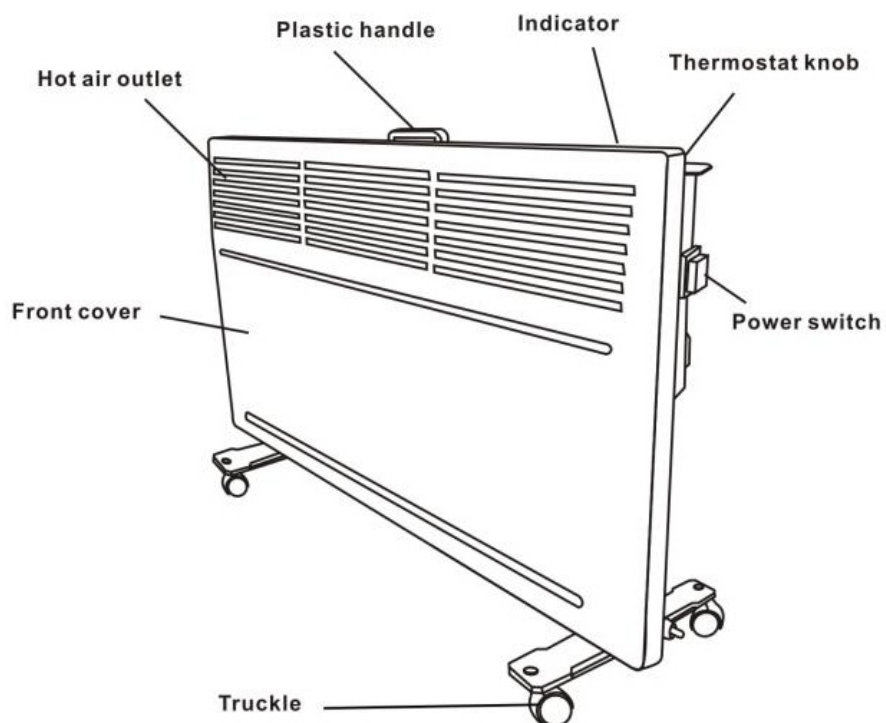

B, Electric Drawing:

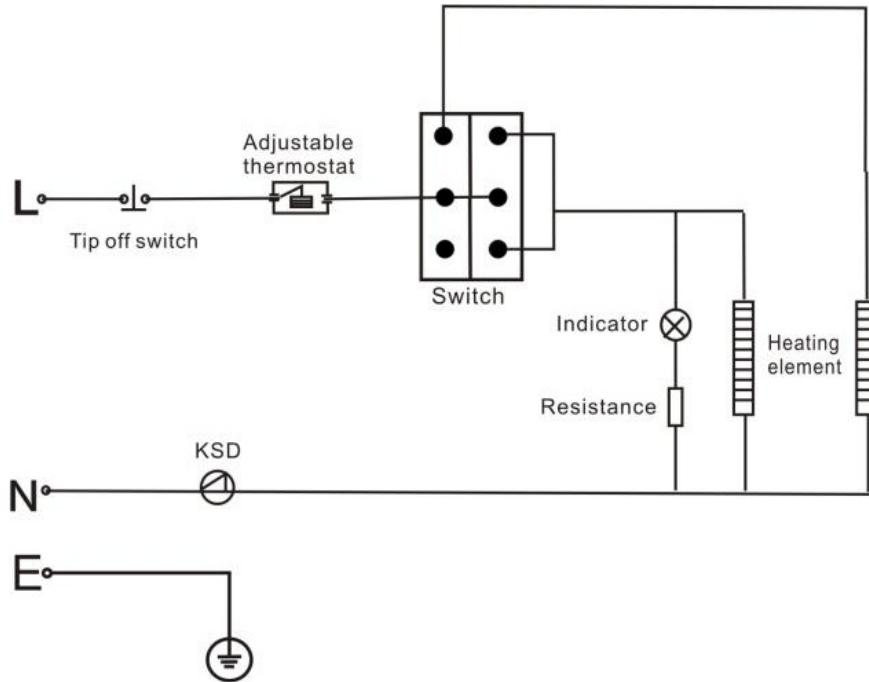

C, Usage:

Before using, please check if the voltage of product are the same of local place.

- Insert the plug into 230V/50Hz socket.
- Press the switch. "O" position is off. "I" position is lower power setting; "II" position is higher power setting.
N60-1: "I" is for 650W, "II" is for 1300W.
- You can change the temperature by turning the thermostat knob which from "MIN" to "MAX". "MIN" position is lowest temperature, "MAX" position is highest temperature.

Installation:

* When using stand unit, put the feet into the fix holes at the bottom of the unit. And then attach with the screws. Place the unit securely on a flat surface

* When using wall mount unit, before drilling the wall make sure the area is free of electrical wires or pipes. To mount your heater to the wall, use the appropriate screws. Reference as the pictures below:

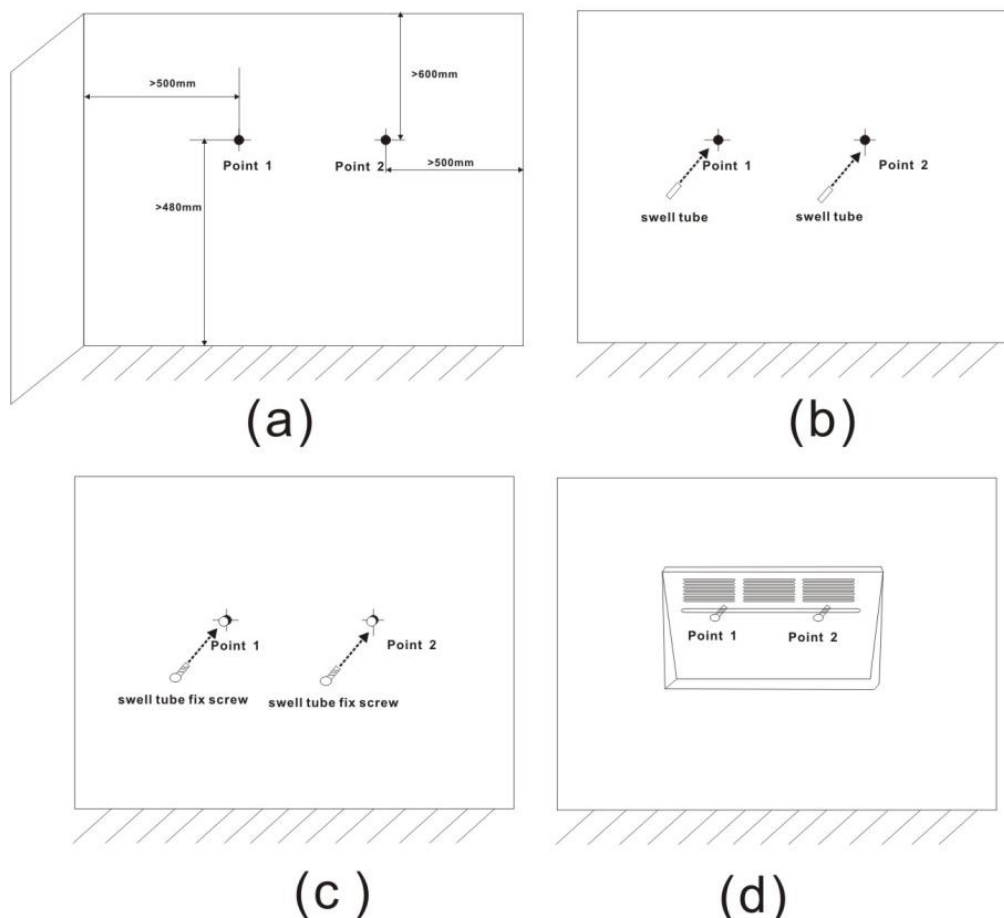

* If there has ceiling or any articles on top of unit, the distance should be bigger than 600mm. The small distance will cause distortion and fire.

Notes:

1. This appliance is not intended for use by persons (including children) with reduced physical, sensory or mental capabilities, or lack of experience and knowledge, unless they have been given supervision or instruction concerning use of the appliance by a person responsible for their safety.
2. Children should be supervised to ensure that they do not play with the appliance.
3. The heater must not be located immediately below a socket-outlet.
4. If the supply cord is damaged, it must be replaced by the manufacturer or its service agent or a similar qualified person in order to avoid a hazard.
5. Cover the appliance or incorrect placement will cause the fire. Do not cover and using convert direction.

6. Before first usage, please check your voltage and frequency is same as rating lable. The socket must be more than 10A for fear of any accident.

7. Before connecting the electricity, please remove the ligation wire in order to prevent overheating.

8. The appliance should be assembled correctly, with feet secured properly. Use the appliance on the flat and stable place. Do not shake the appliance during usage.

9. Do not use the appliance near the flammable, explosive gas and rainfall location. Do not use the appliance in surroundings with electricity leakage and fire. When the environment temperature higher than 30°C, don not use the appliance .Do not use the appliance when nobody is nearby.

10. Do not touch the appliance, metal surface and wind outlet during usage in order to avoid scald.

Do not let children approach the heater. Always keep close supervision of children when in use.

11. Do not put the metal and stick into gap or wind outlet of appliance in order to prevent electric shock.

12. Do not use the same plug or socket-outlet with other big power appliance in order to avoid disaster due to overload.

13. Do not put clothes or objects, on appliance or wind outlet directly in order to avoid burning of the clothes and cause distortion of the unit, or poor performance.

14. While clearing the appliance, please turn off the appliance and plug-off the plug first, and clear after cooling down. Do not use flammable, explosive, toxic cleaning solvent.

15. If there is something wrong with the appliance, do not repair by yourself. It should be sent to the certain repair company to repair by professionals. Contact customer service if you have problems

16. During usage, do not open the window and door often, otherwise it will affect the heating function.

17. Do not use the stand unit without feet fixed.

While assembling the appliance, please stay away from curtain or the other flammable material. Otherwise it will cause the fire and disaster.

18. Never not turn the thermostat or switches, or plug-in / off the plug with wet hands for risk of electric shock.

19. Please turn off and unplug the unit while not in use for long period.

20. Do not use the appliance around the bathtub, shower and swimming pool.

21. In order to avoid overheating, do not cover the heater

22. This appliance can be used by children aged from 8 years and above and persons with reduced physical, sensory or mental capabilities or lack of experience and knowledge if they have been given supervision or instruction concerning use of the appliance in a safe way and understand the hazards involved. Children shall not play with the appliance. Cleaning and user maintenance shall not be made by children without supervision.

23. Children of less than 3 years should be kept away unless continuously supervised.

24. Children aged from 3 years and less than 8 years shall only switch on/off the appliance provided that it has been placed or installed in its intended normal operating position and they have been given supervision or instruction concerning use of the appliance in a safe way and understand the hazards involved. Children aged from 3 years and less than 8 years shall not plug in, regulate and clean the appliance or perform user maintenance.

CAUTION — Some parts of this product can become very hot and cause burns. Particular attention has to be given where children and vulnerable people are present.

Packing list:

NO	NAME	QUANTITY
1	Feet	1set
2	Feet fix screw	8pcs
3	Swell tube	2pcs
4	Swell tube fix screw	2pcs
5	Instruction manual	1pc

If you have any questions, please contact our customer care center.

US

Our contact details are below:

 001-877-644-9366

 customerservice@aosom.com

Imported by Aosom LLC
27150 SW Kinsman Rd Wilsonville, OR 97070 USA
MADE IN CHINA

Si tiene alguna pregunta, comuníquese con nuestro Centro de Atención al Cliente.

ES

Nuestros datos de contacto son los siguientes:

 0034-931294512

 atencioncliente@aosom.es

IMPORTADOR:
SPANISH AOSOM, S.L.
C/ ROC GROS, Nº 15. 08550, ELS HOSTALETES DE BALENYÀ, SPAIN.
B66295775
WWW.AOSOM.ES
HECHO EN CHINA

If you have any questions, please contact our customer care center.

CA

Our contact details are below:

 416-792-6088

 customerservice@aosom.ca

Imported by Aosom Canada Inc.
7270 Woodbine Avenue, Unit 307, Markham,
Ontario Canada L3R 4B9
MADE IN CHINA

Si vous avez la moindre question, veuillez contacter notre centre d'assistance à la clientèle.

Nos coordonnées sont les suivantes:

 416-792-6088

 customerservice@aosom.ca

Importé par Aosom Canada Inc.
7270 Woodbine Avenue, unité 307,
Markham, Ontario Canada L3R 4B9
Fabriqué en Chine

Se tiver alguma dúvida, por favor contacte o nosso Centro de Atendimento ao Cliente.

PT

Os nossos dados de contacto são os seguintes:

 0034-931294512 (SEG-SEX DAS 7:30H ÀS 16:30H)

 info@aosom.pt.

IMPORTADOR:
SPANISH AOSOM, S.L
C.ROC GROS N.15, 08550. ELS HOSTALETES DE BALENYÀ
WWW.AOSOM.PT

Wenn Sie Fragen haben, wenden Sie sich bitte an unser Kundendienstzentrum.

DE

Unsere Kontaktdaten stehen unten:

 0049-0(40)-88307530  service@aosom.de

ADRESSE DES IMPORTEURE:

MH Handel GmbH
Wendenstraße 309
D-20537 Hamburg
Germany
IN CHINA HERGESTELLT

In caso di dubbio, si prega di contattare il nostro centro assistenza clienti.

IT

I nostri dettagli di contatto sono di seguito:

 0039-0249471447  clienti@aosom.it

IMPORTATO DA:
AOSOM Italy srl
Centro Direzionale Milanofiori
Strada 1 Palazzo F1
20057 Assago (MI)
P.I.: 08567220960
FATTO IN CINA

If you have any questions, please contact our customer care center.

UK

Our contact details are below:

 0044-800-240-4004

 enquiries@mhstar.co.uk

IMPORTER ADDRESS:
MH STAR UK LTD
Unit 27, Perivale Park,
Horsenden lane South
Perivale, UB6 7RH
MADE IN CHINA

Si vous avez la moindre question, veuillez contacter notre centre d'assistance à la clientèle.

FR

Nos coordonnées sont les suivantes:

 0033-1-84166106

 aosom@mhfrance.fr

Importé par:
MH France
2, rue Maurice Hartmann
92130 Issy-les-Moulineaux
France
Fabriqué en Chine