

BRÜLIN

BR7DD

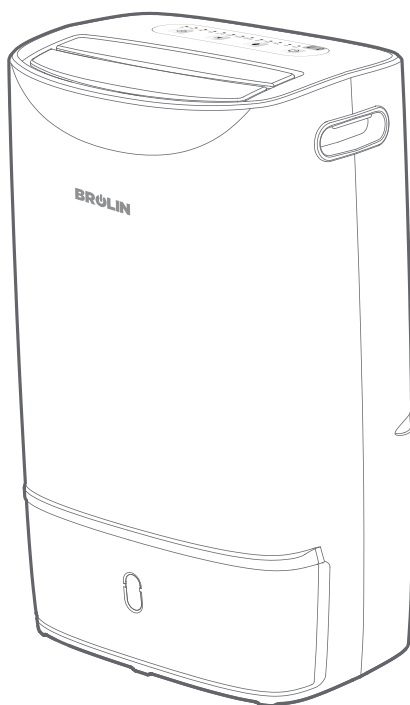

**Please read this instruction manual
before operating and keep safe for future reference**

IMPORTANT SAFETY INSTRUCTIONS

PLEASE READ ALL INSTRUCTIONS CAREFULLY BEFORE OPERATING.

WARNING - This appliance is intended for use in a domestic environment only. Any other use is not recommended by the manufacturer and may cause fire, electrical shocks or other injury to person or property.

When using electrical appliances, basic safety precautions should always be followed:

1. Do not operate the unit with a damaged cord or plug, after it malfunctions or has been dropped or damaged in any way. Return to an authorised service facility for examination and repair.
2. This unit should always be kept in an upright position to avoid any damage. Locate the unit on a flat stable surface.
3. Check the household voltage to ensure it matches the units rated specification before operating.
4. Operate this unit in an ambient temperature between 1°C and 40°C.
5. Ensure that the air inlets and outlets are not blocked or covered.
6. Do not place the unit too close to curtains or other objects - minimum distance 40cm.
7. SoWhen using the unit to dry wet clothes in the room, please keep the clothing at a safe distance from the unit to prevent water from dropping onto the unit.
8. Never place anything on top of the unit and do not cover with any kind of material while in use.
9. This product is intended for domestic and light office use ONLY and not for commercial, industrial or outdoor use. Never use in very damp rooms (bathroom for example).
10. To protect against electrical shocks, do not immerse unit, plug or cord in water, or spray with liquids.
11. Never unplug the power cord without pressing the "Power key" first, as this could damage the unit.
12. Always unplug the unit when not in use or moving location. To disconnect from the power supply, grip the plug and pull from the power socket. Never pull by the cord.
13. Always empty the water tank before storing the unit away.
14. Using the dehumidifier in front of a warm radiator can result in the dehumidifier not collecting any water because of the heat from the radiator.
15. Do not run power cord under carpeting, or cover with rugs or runners. Arrange the cord away from areas where it may be tripped over
16. Never operate or store the unit in direct sunlight.
17. To repair the unit, take it to a qualified service engineer. Repairs carried out by unqualified people may cause damage to the unit or injury to persons or property and void the warranty.
18. Where possible, avoid the use of an extension cable as they may overheat and cause a risk of fire. Only use an extension cord after ensuring it is in perfect condition.
19. Do not use the unit without the air filter and make sure that the filter is kept clean to avoid malfunction and invalidating the warranty.

This appliance is not intended for use by persons (including children) with reduced physical, sensory or mental capabilities, or lack of experience and knowledge, unless they have been given supervision or instruction concerning use of the appliance by a person responsible for their safety. Children should be supervised to ensure that they do not play with the appliance.

SAVE AND READ THESE IMPORTANT SAFETY INSTRUCTIONS

FEATURES

- **Compressorless dehumidifier** ~ uses desiccant rotor technology
- **Environmentally friendly** with no harmful gasses & quiet in operation
- **Moisture removal** ~ 7 L/d (20°C, 60%RH)
- **Water tank capacity** ~ 2.4 L
- **Automatic dehumidification** according to power level (H/L) and humidity settings
- **2, 4, 8, 12 hours timer**
- **Temperature range for use** ~ 1°C - 40°C
- **Light & portable with carry handle**
- **Removable water bucket with handle**
- **Auto restart after power cut**
Once the power is restored after a power failure, the appliance will continue to operate at the selected settings prior to the power failure.
- **Versatile adjustable louver**
2 independent blades can be freely adjusted

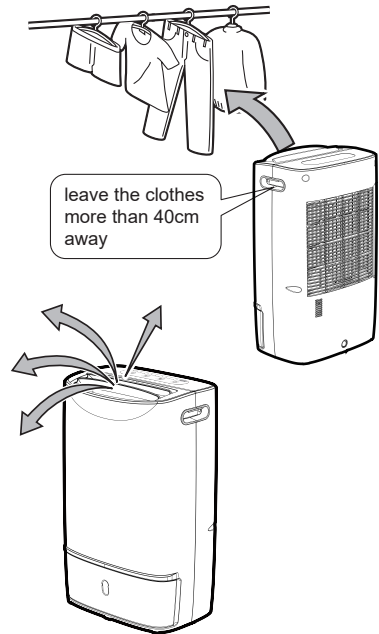

PRODUCT DESCRIPTION

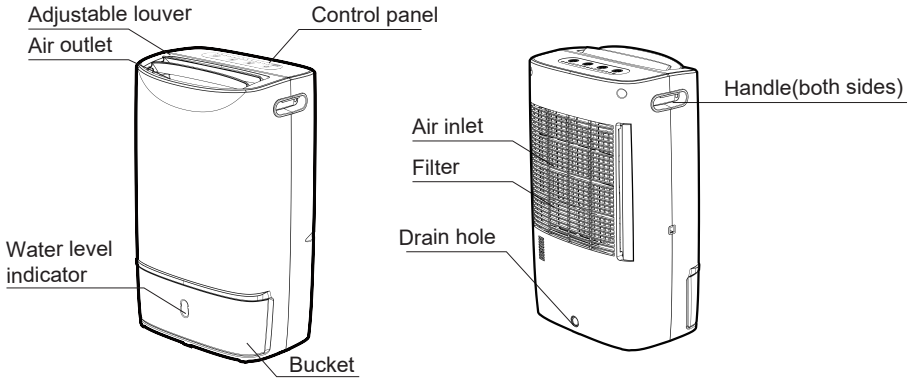

THE CONTROL PANEL

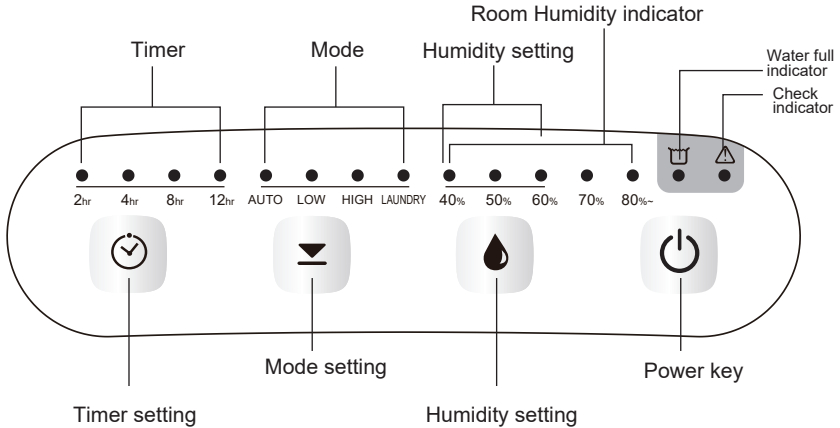

Note: The room humidity display and humidity settings are displayed with single or two LEDs, e.g. both 40% and 50% mean 45%.

UNIT SETUP

- Place the unit in an upright position on a stable, flat surface.
- Please ensure the unit is a safe distance away from a wall or furniture (see the right graphic).
- Please keep clothes at a safe distance of 40 cm from air outlet of the unit to prevent water dripping into the unit.
- Where to position your dehumidifier?
For best results position the dehumidifier somewhere central like a landing or a hallway. Do not position in front of a radiator or in direct sunlight.

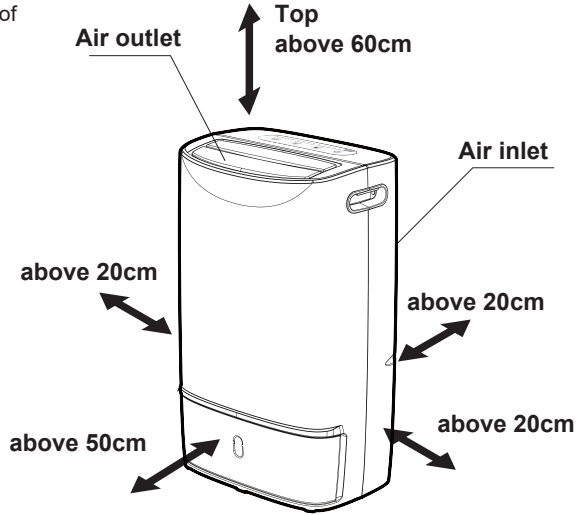

TO OPERATE SAFELY

- Open the louver (blades) before operating.
- Do not insert small objects into the unit or this will damage it and cause a hazard.
- Keep suitable space as above.
- Do not remove bucket when running or water may leak.
- Ensure bucket is fitted correctly, if the bucket is full or is not in place, the water full indicated and the machine stops.

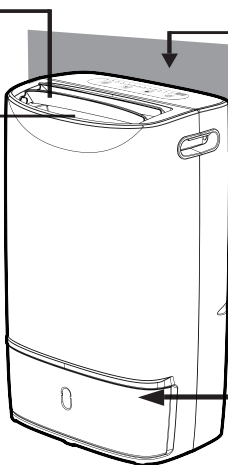

Power key

Note: Be aware to open louvers to let air flowing to desired directions when operating.

The appliance will be on with prior settings of last run, including humidity and fan settings, except timer.

Once the power is restored after a power failure, the appliance will continue to run the prior settings (including timer) before power failure.

Humidity setting

Press the humidity setting button to set the humidity in the following loops with 1 or 2 LED, 5% stage display:

→ 40% → 45% → 50% → 55% → 60% →

When the humidity setting is higher than the indoor humidity, the humidity setting LED flashes and the machine will enter the energy saving pause state (HEATER turns OFF, and the machine stops after 2 minutes of cooling operation). If the humidity is higher than 5% of the set value, the machine will restart.

After 30 minutes pause, the fan will start to run 2 minutes for checking indoor humidity. The product will retrieve to work whenever the humidity level being increased 5% from the wanted level. If not, it stops for another 30 minutes. During the pause, buttons are settable though the fan stops.

Mode setting

Press the MODE button to select modes in the following loop:

→ AUTO → LOW → HIGH → LAUNDRY →

AUTO: the fan speed and heater are controlled from low to high when room humidity is 10% higher than the setting, and turn from high to low when only 5% or less higher.

LOW: the machine runs with low fan speed and low heater.

HIGH: the machine runs with high fan speed and high heater.

LAUNDRY: the humidity setting is disabled (all the humidity setting LEDs are off) and the machine runs continuously with high fan speed and high heater.

Timer setting

Press the TIMER button to set the timer. The remaining time will be displayed along with the running.

→ 2hr → 4hr → 8hr → 12hr → continuous (no led) →

TO EMPTY THE BUCKET

1. When the bucket is full, the  LED blinks and the unit stops in a few minutes.
2. Do not move the unit or remove the bucket if the machine is still operating, as water may leak, damage the unit or cause an electric shock.
3. To remove the bucket, pull it out and lift carefully.
4. Pour the water away, clean the bucket and restore the cover and the bucket to the correct position.

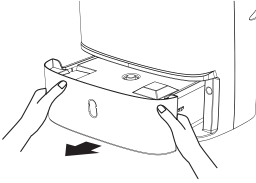

A Pull bucket out

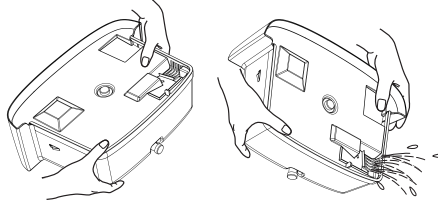

B Pour water away

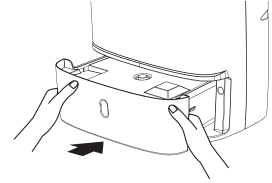

C Restore the bucket

NOTE :

- Clean the bucket with clean water if needed. Do not use solvent, abrasive or hot water.
- Do not remove or damage the float in the bucket, or the unit cannot work correctly.
- The  LED blinks if the bucket is not well in place.

TO DRAIN WATER

You may use a hose with an inner diameter of 12mm for continuous drainage:

1. Use a screwdriver to remove the knockout at the back. Attach the tubing to the connector through the hole.
2. The tubing shall be lead to the drain with no sharp bends.

Note:

The bucket must be in the correct position before tubing.

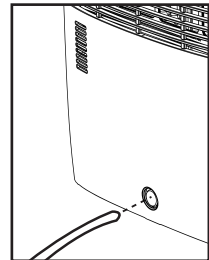

Cleaning the unit

1. Turn off the unit, wait for the fan to stop and unplug from the power socket.
2. Clean the surface with a soft damp cloth.
3. Dry thoroughly with a towel after cleaning.
4. In order to avoid damage, do not wash the machine with water, or let water drip into the air inlet or outlet.

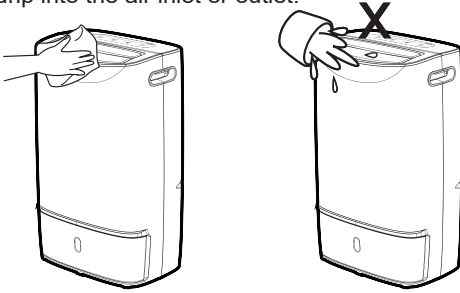

Cleaning the filter

If the filter is covered with dust, the airflow and the performance of the unit will be affected. It is recommended to check and clean the pre-filter every month.

1. Turn off the unit and remove the filter from the unit.
2. The pre-filter can be washed and wiped gently.
3. Replace the filter in position.

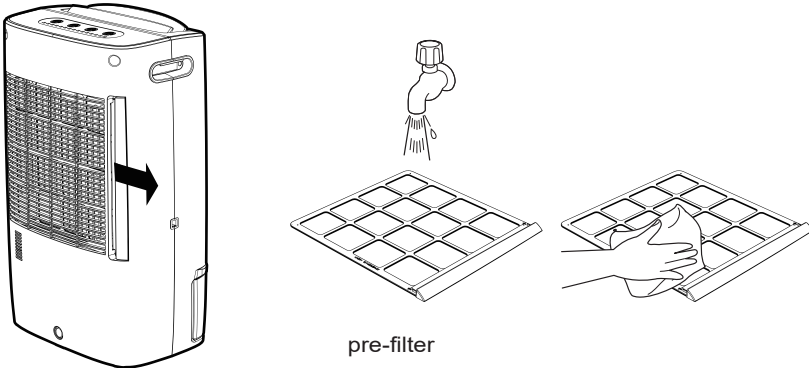

Before storing

1. Turn off the unit, wait for it to stop and unplug from the power socket.
2. Clean and dry the bucket. Leave the unit to drain for approximately one day.
3. Clean the filter and the unit. Cover the unit to prevent it from gathering dust.
Store uprighting in a cool dry place.
4. Do not expose to direct sunlight.

TROUBLE SHOOTING

Issue	Possible Solution
The fan is still running about 2 minutes after the unit is turned off.	This is normal function of the unit and not a cause for concern.
The unit works within room temperature about 1~40°C. It will stop operation out of this range.	This is normal, as the unit is designed to only work within this temperature range.
The unit is emitting an unusual odor	This is a normal and harmless by product of the zeolite desiccant material. The smell occurs because the zeolite absorbs odors from cigarettes, cosmetics, hair sprays, building materials and new furniture, and when heated discharges the odor into the room.
The  LED is blinking to signify a blockage in the air inlet or outlet	The filter is dirty or clogged. Please clean or replace.

WARNING: If any other issue persists, contact your retailer or a qualified service professional. DO NOT try to repair this unit yourself, as doing so could lead to risk of electric shock and the voiding of your warranty.

SPECIFICATIONS

Model	BR7DD
Power consumption(H)	640W
Power supply	220-240V~ 50Hz
Dehumidifying capacity	7 L/d (20°C,60%RH)
Capacity water container	2.4 L
Operating range	1 ~ 40°C
Dimensions (w x d x h)	W301 x D209 x H481mm
Net weight	6.0kg
Gross weight	7.0kg

Sunbelt Rentals Ltd
National Distribution Centre
Orchard Way
Sutton in Ashfield
NG17 1JU
Tel: 0330 175 9558